

STATE OF TEXAS,  
 COUNTY OF HARRIS:  
 WE, R.L. PHILLIPS AND D.E. DIVEN, PRESIDENT AND SECRETARY RESPECTIVELY OF BRIARGROVE CONSTRUCTION CO., OWNER OF THE PROPERTY SHOWN SUBDIVIDED IN THE ABOVE AND FOREGOING MAP OF BRIARGROVE, SECTION 5, DO HEREBY CERTIFY THAT THE LOTS, BUILDING LINES, STREETS, ALLEYS, PARKS AND DRIVEWAYS LOCATED THEREON SHOWN AND HEREIN SET FORTH ARE IN ACCORDANCE WITH THE CITY PLANNING COMMISSION OF THE CITY OF HOUSTON, TEXAS, THIS 5th DAY OF JULY, 1955.

THIS IS TO CERTIFY THAT WE, R.L. PHILLIPS AND D.E. DIVEN, PRESIDENT AND SECRETARY RESPECTIVELY OF BRIARGROVE CONSTRUCTION CO., OWNER OF THE PROPERTY SHOWN SUBDIVIDED IN THE ABOVE AND FOREGOING MAP OF BRIARGROVE, SECTION 5, HAVE COMPLIED WITH THE EXISTING HARRIS COUNTY ROAD LAW AS AMENDED BY HOUSE BILL 636, 53RD LEGISLATURE AND ALL CITY ORDINANCES HERETOFORE ON FILE WITH THE COUNTY ENGINEER AND ADOPTED BY THE COMMISSIONERS COURT OF HARRIS COUNTY.

I, E.D. MCGRORY, TRUSTEE,  
 OWNER AND HOLDER OF LENS UPON SAID PROPERTY, DO HEREBY RATIFY AND CONFIRM TO SAID SUBDIVISION AND DEDICATION THE LIENS AGAINST SAID LAND OWNED AND HELD BY ME.

THERE IS ALSO DEDICATED FOR UTILITIES AN UNDISTURBED AERIAL EASEMENT 10 FEET WIDE FROM A LINE TWENTY (20) FEET ABOVE THE GROUND UPWARD LOCATED ADJACENT TO ALL EASEMENTS SHOWN HEREON.

FURTHER, WE DO HEREBY DEDICATE FOREVER TO THE PUBLIC A STRIP OF LAND 10 FEET WIDE ON EACH SIDE OF THE CENTER LINE OF ANY AND ALL GULCHES, DRAINAGE CANALS, DITCHES OR OTHER DRAINAGE COURSES LOCATED WITHIN SAID SUBDIVISION, AS SET FORTH ON THE ABOVE MAP, TO THE PUBLIC AGENCY THE RIGHT TO ENTER UPON SAID GULCHES, DRAINAGE CANALS, DITCHES OR OTHER DRAINAGE COURSES FOR MAINTENANCE AND ALL THINGS NOW AND TO BE CONSTRUCTED UNDER MAINTENANCE SHALL BE WORK AND/OR STRUCTURES.

FURTHER, ALL OF THE PROPERTY SHOWN SUBDIVIDED IN THE ABOVE AND FOREGOING MAP SHALL BE RESTRICTED TO RESIDENTIAL USE. NO INDUSTRIAL OR COMMERCIAL USE SHALL BE PERMITTED ON ANY AND ALL LOTS SHOWN SUBDIVIDED IN THE ABOVE AND FOREGOING MAP. THE DRAINAGE OF GULCHES, DITCHES OR OTHER DRAINAGE COURSES LOCATED WITHIN SAID SUBDIVISION SHALL BE UNDER PRIVATE DRAINAGE STRUCTURES UNDER PRIVATE DRIVEWAYS SHALL HAVE A 12" DRAINAGE STRUCTURE UNDER PRIVATE DRIVEWAYS AND A 18" DRAINAGE STRUCTURE UNDER PUBLIC DRIVEWAYS. ALL DRAINAGE STRUCTURES SHALL BE A MINIMUM OF ONE AND THREE QUARTERS (1 3/4) SQUARE FEET PER LINEAL FOOT OF DRAINAGE. ALL DRAINAGE STRUCTURES SHALL BE CONSTRUCTED TO THE CITY OF HOUSTON AND/OR HARRIS COUNTY ENGINEER AND/OR TRUSTEE. DRIVEWAYS LOCATED WITHIN SAID SUBDIVISION SHALL NOT HAVE DIRECT DRIVEWAY ACCESS TO SAID STREET.

THE CITY PLANNING COMMISSION OF THE CITY OF HOUSTON, TEXAS, HAS CAUSED THIS PLAN AND SUBDIVISION OF BRIARGROVE, SECTION 5, TO BE APPROVED BY R.L. PHILLIPS, ITS PRESIDENT, AND D.E. DIVEN, ITS SECRETARY, AND IT IS HEREBY AUTHORIZED BY THE CITY ENGINEER AND SECRETARY OF THE CITY PLANNING COMMISSION OF THE CITY OF HOUSTON, TEXAS, THIS 5th DAY OF JULY, 1955.

ATTEST: *[Signature]* BY *R.L. Phillips* SEAL  
 SECRETARY

WITNESS OUR HAND IN HOUSTON, HARRIS COUNTY, TEXAS, THIS 5th DAY OF JULY, 1955.

STATE OF TEXAS,  
 COUNTY OF HARRIS:  
 I, R.L. PHILLIPS, PRESIDENT OF BRIARGROVE CONSTRUCTION CO., DO HEREBY CERTIFY THAT THE ABOVE SUBDIVISION COMPLIES WITH ALL THE EXISTING RULES AND REGULATIONS OF THE CITY OF HOUSTON, TEXAS, AND THAT THE ABOVE SUBDIVISION IS IN ACCORDANCE WITH THE CITY PLANNING COMMISSION OF THE CITY OF HOUSTON, TEXAS, THIS 5th DAY OF JULY, 1955.

NOTARY PUBLIC IN AND FOR HARRIS COUNTY, TEXAS:  
*[Signature]*  
 SEAL

THIS IS TO CERTIFY THAT I, R.L. PHILLIPS, A REGISTERED ENGINEER OF THE STATE OF TEXAS, HAVE PLANNED THE ABOVE SUBDIVISION FROM AN ACTUAL SURVEY ON THE GROUND AND THAT ALL BLOCK CORNERS, ANGLE POINTS, AND POINTS OF CURVE ARE PROPERLY MARKED WITH I.C.S. 3" LINES, 3" LONG, AND THAT THIS PLAN CORRECTLY REPRESENTS THIS SURVEY MADE BY ME.  
*R.L. Phillips* SEAL  
 ENGINEER, TEXAS REGISTRATION NO. 3158

THIS IS TO CERTIFY THAT THE CITY PLANNING COMMISSION OF THE CITY OF HOUSTON, TEXAS, HAS APPROVED THIS PLAN AND SUBDIVISION OF BRIARGROVE, SECTION 5, AS SHOWN ON THE ABOVE MAP, AND IT IS HEREBY AUTHORIZED BY THE CITY ENGINEER AND SECRETARY OF THE CITY PLANNING COMMISSION OF THE CITY OF HOUSTON, TEXAS, THIS 5th DAY OF JULY, 1955.

ATTEST: *[Signature]* BY *Jean Andrews* SEAL  
 SECRETARY

I, M.R. JENSEN, FLOOD CONTROL ENGINEER OF HARRIS COUNTY, TEXAS, DO HEREBY CERTIFY THAT THE ABOVE SUBDIVISION COMPLIES WITH ALL THE EXISTING RULES AND REGULATIONS OF THE CITY OF HOUSTON, TEXAS, AND THAT THE ABOVE SUBDIVISION IS IN ACCORDANCE WITH THE CITY PLANNING COMMISSION OF THE CITY OF HOUSTON, TEXAS, THIS 5th DAY OF JULY, 1955.

APPROVED BY THE COMMISSIONERS COURT OF HARRIS COUNTY, TEXAS, THIS 5th DAY OF JULY, 1955.  
*[Signature]* COUNTY ENGINEER  
*[Signature]* COUNTY JUDGE  
*[Signature]* COMMISSIONER DISTRICT 1  
*[Signature]* COMMISSIONER DISTRICT 2  
*[Signature]* COMMISSIONER DISTRICT 3  
*[Signature]* COMMISSIONER DISTRICT 4

I, W.D. MILLER, CLERK OF THE COUNTY COURT OF HARRIS COUNTY, TEXAS, DO HEREBY CERTIFY THAT THE WITHIN INSTRUMENT WITH ITS CERTIFICATE OF AUTHENTICATION WAS FILED FOR REGISTRATION IN MY OFFICE ON 1955 AT 11:00 O'CLOCK AM AND FULLY RECORDED ON 1955 AT 11:00 O'CLOCK AM IN VOLUME 100 OF RECORDS OF HARRIS COUNTY TEXAS. WITNESS MY HAND AND SEAL OF OFFICE, AT HOUSTON, THE DAY AND DATE LAST ABOVE WRITTEN. W.D. MILLER, CLERK COUNTY COURT, HARRIS COUNTY, TEXAS.

SECTION 5 OF BRIARGROVE. A SUBDIVISION IN THE ROBERT VINCE SURVEY, COMPRIZING 6315 ACRES IN BLOCKS AND 35 LOTS DEVELOPED BY BRIARGROVE CONSTRUCTION CO. ENGINEER R.L. PHILLIPS. SCALE 1"=100' DATE APRIL 1, 1955.

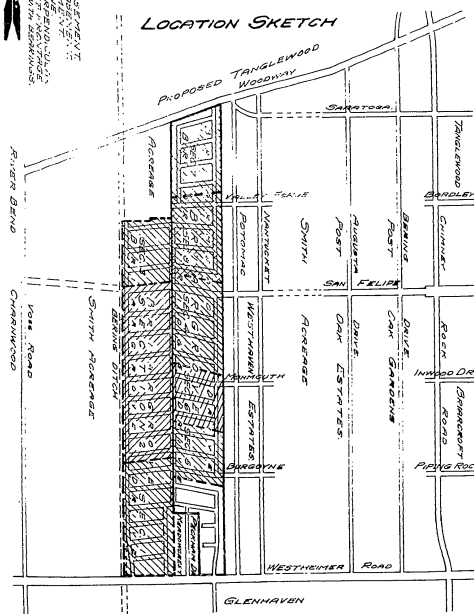

1451992  
 JUL 7 1955

W.D. MILLER, CLERK COUNTY COURT, HARRIS COUNTY, TEXAS.  
 W.P. Wiseman, Deputy